



altro

the future is safer with altro



Altro's definitive guide to sector issues

# EDUCATION

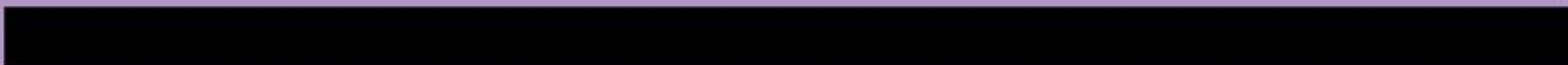





the future is safer with altro

a l t r o

## Welcome to The Source:

This is the complete Altro guide to responsibility, helping you to protect your business and adding value on the key issues of legislation, safety, hygiene and sustainability, in the education sector. Inside, we have shared our knowledge, so that you can make well-informed decisions on your specifications and stay one step ahead.

### Responsibility in the education sector

In this edition of The Source, you will find a guide to specifying floors, walls, ceilings and doors in universities, colleges, secondary and primary schools, specialist schools - special needs / academies, plus nurseries.

We have demonstrated the potential issues, rules and regulations that Altro solutions can help you and your organisation overcome and ultimately enable you to achieve a greater level of responsibility in an increasingly litigious world.

### Altro and you

As the inventor of safety flooring and innovator in hygienic wall cladding, Altro have over 50 years' experience and are specialists in the education sector.

Our aims are to continually improve the performance and enhance the design of all our products, whether it is the slip resistance of safety flooring or the hygiene of wall cladding. We offer you a portfolio of stylish and stimulating products, to create the right environment in which to nurture students and welcome guests. All products are tried and tested in the most demanding of educational establishments to ensure that they meet current standards and are fit for purpose. Furthermore, our Altro Assurance of Customer Satisfaction is a unique expression of our commitment to provide you with exceptional supply, service and support.

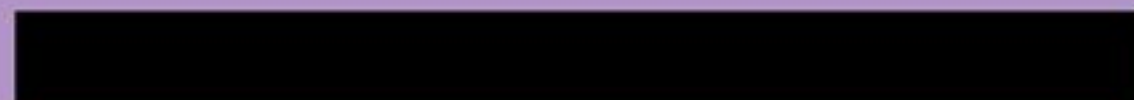



# altro SOLUTIONS

## ALTRO SAFETY FLOORING

Altro's unique achievements as pioneers of safety flooring have revolutionised the market. You now have unrivalled choice in product design, improved cleanability and colour retention, giving you the scope to create stimulating and welcoming learning environments.

Altro's extensive range of safety flooring offers the highest standards in slip resistance. Specialist flooring options provide the perfect solution for different problem areas, such as laboratories, reception areas, kitchens, art rooms and technology suites, making Altro safety flooring the perfect partner for education.



## Benefits

### Hygienic

- Seamless and impervious, hygienic finish
- Features Altrosan™ integral bacteriostat
- Coved installations with rounded corners give bacteria nowhere to hide
- Hygienic alternative to carpets and tiles
- Can be laid to fall and incorporate gullies, drains and floor mounted toilet systems

### Enhances the working environment

- Wide range of colours and finishes for all requirements
- Stain resistant from ground-in pen ink and paints
- Comfortable and warm underfoot for nurseries and play areas
- Sound absorption for quiet areas
- Bespoke designs, signage/zoning inlays for ease of navigation
- Static dissipative Altro Walkway™ BS EN 14041, which refers to EN 1081 for server rooms and EN 1815 for general areas – floor does not accumulate static charge above 2 kV
- Wet grade available for wet and dry play areas

### Slips & Trips

- Slip-resistant even when wet or dusty
- Slip-resistant throughout the life of the flooring
- Exceeds the HSE SRV36 point safety standard (UK)

### Long lasting

- Ranges which include impact, chemical and spillage resistance
- 2-4mm resilient options to withstand intensive usage
- 7, 10, 12 or 15 year warranties
- Proven durability, installations that stand the test of time



EN14041  
0120  
GB06-72664

Manufactured by  
Altro Ltd, Works Road  
Letchworth, Garden City SG6 1HR  
United Kingdom





## Product Details

Typical applications are shown in italics. These do not represent an exclusive list. For your exact project requirements please contact Altro directly. All Altro Safety Flooring is BRE A+ rated, contributing to BREEAM Ecopoints.

### *CLASSROOM AND CIRCULATION*

#### **Altro Mirica™, Altro Suprema™ and Altro Timbersafe™ II**

- Modern ranges of slip-resistant 2mm safety flooring
- Designed for public application areas or where traditional sparkle is undesirable
- Impervious and hygienic with Altro Maxis™ Easyclean Technology
- Impact resistant, comfortable underfoot

#### **Altro Mirica™**

- Maintains appearance in high traffic areas despite scuff marks and soiling
- Perfectly complements Altro Suprema

#### **Altro Suprema™**

- Subtle look to accentuate your design
- Perfectly complements Altro Mirica

#### **NEW Altro Timbersafe™ II**

- Traditional, homely wood finish without compromising slip resistance
- Increased to 9 wood-effect finishes

### *CLASSROOM AND CIRCULATION*

#### **Altro Walkway™ 20**

- 2mm slip-resistant flooring, excellent durability
- Incorporates bacteriostat for enhanced hygiene

### *HEAVY TRAFFIC AREAS*

#### **NEW Altro XpressLay™**

- Adhesive-free, no damp-proof membrane required
- Direct fitting at 97% relative humidity
- Same day welding
- Immediate walking on floor
- Economical, fast, hassle-free installation

### *KITCHENS*

#### **Altro Stronghold™ 30**

- Heavy duty 3mm kitchen grade safety flooring
- Ideal in wet/greasy conditions, with frequent spillages
- Good acoustic and comfort properties

### *SHOWERS, POOLS, CHANGING ROOMS, SPAS AND WET PLAY AREAS*

#### **Altro Marine™ 20**

- Textured 2mm thick surface, for safety with wet, bare feet
- Integral bacteriostat
- Coordinates with Altro Walkway or Altro Impressionist

### *LABS, TECH/ENGINEERING ROOMS, HEAVY DUTY AREAS*

#### **Altro Atlas™ 40**

- 4mm thick, extremely tough
- Enhanced resistance to mechanical/chemical damage
- Low maintenance and life cycle costs

Altro Everlay™ underlayment overcomes the problems that may be encountered laying sheet flooring over old tiles, sheet metal, subfloors contaminated with oil or paint, or permeated with damp. When you combine Altro safety flooring with Altro acoustic underlay 1101 the combination enhances dB output to 17dB. For further details on both products contact Altro Technical Services on 01462 707600.







**Altro Whiterock™ fits to Altro Marine™ 20 safety flooring  
shower tray for a watertight system**

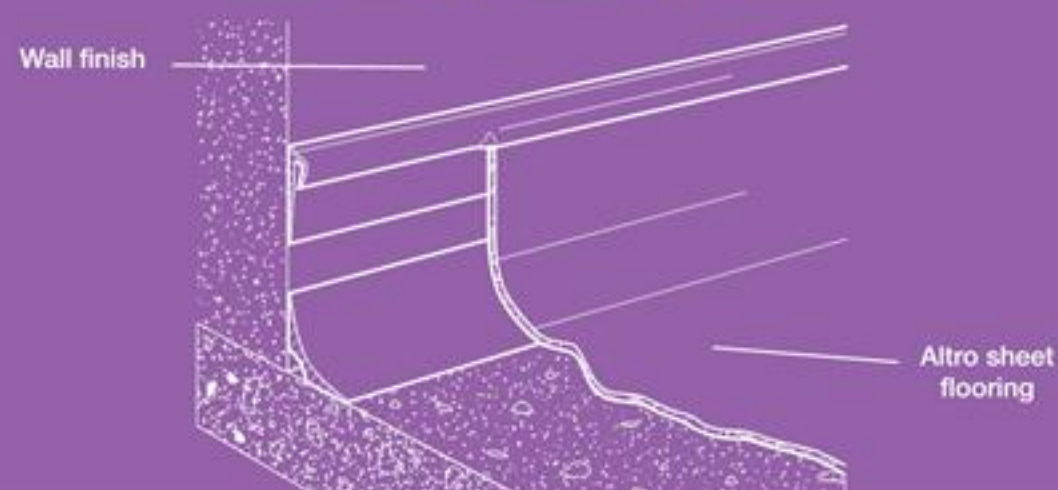

**Altro sheet flooring with clamping drain outlet creates  
a hygienic and waterproof installation**

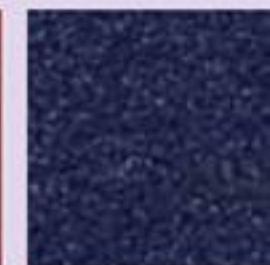

FOR FURTHER PRODUCT DETAILS, TO ORDER SAMPLES OR  
ARRANGE AN ON-SITE CONSULTATION, CALL TODAY ON

**+44 (0) 1462 707600**

OR VISIT [www.altro.com](http://www.altro.com)







## Case Studies

Location: **Nobel School, Stevenage**

Product: **Altro Mirica™**

"The new Mirica floor is really innovative and shows that schools don't just have to stick dull colours in their corridors... its fresh, dynamic look hits you immediately. Over time, corridors can start to look tired due to high footfall and the marks made by people walking down them. The patterned effect will hide these marks and help keep the floor looking as fantastic as it does now."

Alistair Crag,  
Headteacher



Location: **John Wheatley College**

Product: **Altro Walkway™ 20**

"The previous flooring in the salon was also Altro Walkway, which after many years of use, had kept its appearance and slip resistance. I have no doubt that our old Walkway flooring could have stood up to years of further wear and tear, but this year we had the budget to carry out a larger programme of refurbishment that included the salon.

It made sense for us to replace like-for-like, as from experience we know Altro Walkway is robust enough to stand up to daily pounding. I'm confident that our new Walkway flooring will help to keep our staff, students and visitors safe for the next decade or even longer."

John McKay,  
Facilities Manager



# altro

## THE ISSUES

Employers and organisations have a duty of care to every employee, student and visitor within their establishment. As regulations become increasingly demanding and society ever more litigious, it is essential to provide and maintain a safe environment for all.

### THE FACTS: SLIPS AND TRIPS

The European Commission's "Campaign for a Safer EU" aims to reduce slip and trip accidents by 25% by 2012.

Currently 55% of all accidents in education are caused by a slip or trip. In 2008, the HSE reports almost 2,000 major injury slip and trip accidents in the education sector; 571 of which were to employees, representing a 5% increase on 2007. Of these 2,000 injuries, 90% suffered broken bones, causing considerable personal distress and a significant amount of time away from work.

The education sector in particular places heavy demands on its flooring. Its risk areas typically include slopes, steps, heavy traffic circulation areas, play and sports areas, kitchens, student union bars, launderettes, laboratories, art, technology and computer suites. These are all busy places that present significant risk on their own, which can be aggravated by the behaviour of the young, who do not always appreciate their role in accident prevention. A further risk is presented by the threat of contamination (through water, food, litter and chemicals), which can seriously alter the performance of the flooring if not adequately provided for.

All Altro safety floors for shoed traffic have a Slip Resistant Value (SRV) of SRV36 or above as recommended by the HSE (Health and Safety Executive) and provide underfoot traction to assist with walking and safety.

*For further information, request a copy of Altro's Slips and Trips Guide.*

### Health & Safety Executive (HSE)

- The HSE Education Information Sheet states, "Ensure consideration is given to eliminating slip and trip risks during the design stage of the changes – for example, installation of a slip-resistant floor"
- In classroom areas, "Provide coat hooks/racks for drying wet clothing – consider siting such areas on specialist anti-slip flooring as even drips of rain water on smooth surfaces can be enough to result in slips"
- Many slips occur in kitchens and food serveries. Equipment and work surfaces should be maintained to avoid contamination of the floor surface. Floor surfaces should be non-slip and appropriate for use in kitchens (please refer to the Altro Kitchen Handbook for Altro Stronghold™/K30 solutions)
- For further information, please refer to the HSE guide Preventing Slip and Trip Incidents in the Education Sector





## THE FACTS: CONSTRUCTION DESIGN MANAGEMENT (CDM)

- According to CDM regulations, the designer is responsible for assessing the potential hazards associated with floor and wall coverings, eg hazardous substances, installation methods, safety in the use of the floor, safe cleaning, maintenance and replacement methods. Risks and counter measures should be considered



## THE FACTS: DISABILITY DISCRIMINATION ACT (DDA)

- To enable optimum orientation and movement through buildings by visually impaired or disabled users, consideration should be given to the slip resistance, texture, colour, pattern, contrast, resilience and acoustics of floors and the contrast between walls and floors
- All Altro safety floors for shoed traffic have a Slip Resistance Value (SRV) of SRV36 or above as recommended by the HSE and provide underfoot traction to assist with walking and safety
- The DDA states highly reflective surfaces should be avoided – Altro produces a range of non-sparkle safety flooring and low gloss, satin finish wall cladding
- All Altro products are Light Reflectance Value (LRV) rated to enable accurate DDA colour and contrast specification
- Altro's large palette of bright and muted colours appeals to a wide range of requirements
- Altro Everlay™ and Acoustic 1101 provide added acoustic benefits. For further information, refer to Building Bulletin 93 – Acoustic Designs of Schools
- Altro floors and walls are impact resistant. Furthermore, Altro safety floors are resistant to point loading and scuffing from rubber wheels and walking aids
- For further information, please refer to Building Regulations Part M (Approved Document M – Access to and use of buildings) and Building Standard BS 8300





## THE FACTS: HYGIENE

- According to the World Health Organisation indirect contact is the most frequent route of infection transmission. Thorough cleaning, backed by the installation of impervious and easy to clean surfaces, is the most effective method of combating the spread of infection. Kitchens and bathrooms are particularly vulnerable, see BOG STANDARD. It is important that equipment and surfaces should be designed for ease of cleaning and be made from materials that won't harbour micro-bacterial growth
- Kitchens require hygienic products with proven independent testing, for example Hazard Analysis and Critical Control Points (HACCP); products that are coved, incorporating gullies and drains, suitable for wet, greasy and dusty environments, resistant to cracks, stains, bacteria and water infiltration, broken glass (for student bars) etc
- Altro floor and wall solutions are HACCP approved and offer easy to clean surfaces with low dirt retention - no harsh chemicals are required for cleaning, not only saving time and money, but also being more environmentally friendly, resulting in better working conditions for cleaning operatives and facility users
- For further information, please refer to Altro's Kitchen Handbook

## THE FACTS: BOG STANDARD

- The UK campaign to promote better toilets for pupils advises that the condition of school toilets can affect children's physical and psychological health. Toilets that are unpleasant or out of bounds can cause serious, long-term health problems. Students who do not drink enough water or who actively avoid using unpleasant toilets can suffer loss of concentration and tiredness
- Altro flooring and wall cladding products for use in toilet areas are easy to clean and maintain, without the need for harsh chemicals. They retain their appearance over the life of the product, making them highly cost-effective. For added hygiene, Altro wall cladding and safety flooring ranges contain Altrosan™, an integral bacteriostat to inhibit the growth of bacteria
- Altro have pioneered Altro Easyclean Technology to enable quick and efficient cleaning. Cleaning and maintenance manuals are provided with all installations
- Altro's portfolio boasts a wide range of colours, finishes and patterns to offer you excellent design options



## THE FACTS: WEAR AND TEAR

- The bigger the foot, the more durable the floor requirement. With many universities catering for 40,000 students and more, the demands on flooring in education have never been tougher
- Altro recommend safety flooring of 2.5mm or above for high traffic areas
- Altro safety flooring withstands foot traffic, chair scraping, regular furniture movement, has high point loading (is resistant to dents from swinging on one leg of a chair)
- Altro Maxis Technology reduces the stain effect of powder paints, when mopped up quickly
- Altro flooring and wall cladding are resilient and designed to withstand high usage and daily knocks and scrapes. A hard-wearing Altro floor covering, wall covering or doorset will give many years' service, remaining safe and easy to maintain, with long lasting appearance retention, thereby avoiding the need for regular replacement, which reduces downtime and life cycle costs

## 30 year life cycle cost analysis

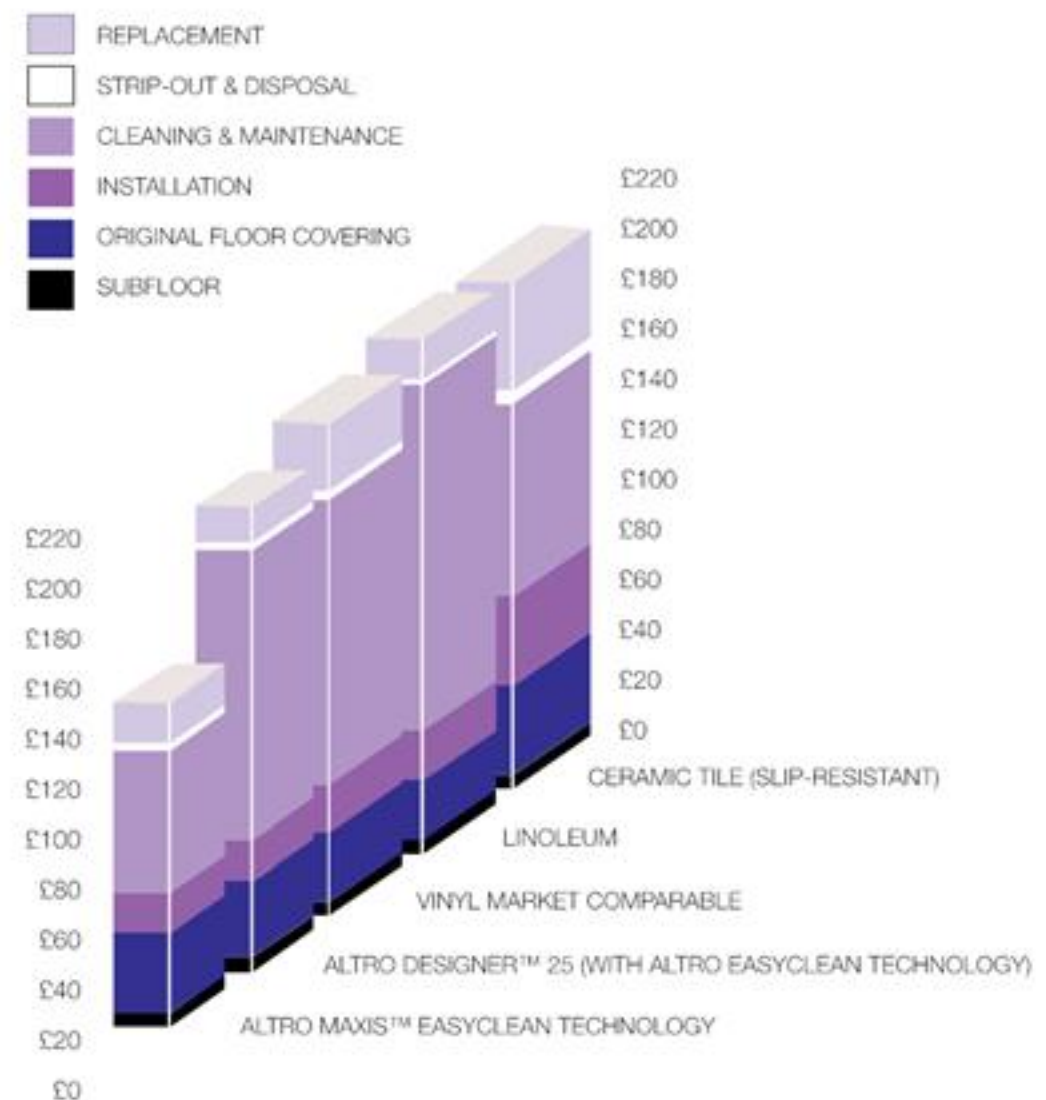

Life cycle cost analysis by BWA Facilities Consultancy. All original material costs were taken from trade price lists, with subfloor and installation costs obtained from Construction Industry price books.

+44 (0) 1462 707600 [www.altro.com](http://www.altro.com)





# altro

## SOLUTIONS OVERVIEW

Altro flooring, walls and ceilings offer cost-effective solutions to the design, hygiene and safety demands of the education sector regulations.

### Altro assurance - support at every stage

- Altro inspection service: pre and post specification and installation support by qualified consultants
- Advice at initial specification: Altro consultants and Technical Services Department work with you on clarification of criteria for new build or refurbishment projects and specific flooring and walling needs
- Sampling service: Altro's 24 hour sample express service
- Specialist wall cladding Premier Installers: trained by Altro, capable of installing Altro products to exacting standards
- Flooring contractors: we can provide contact details of local flooring contractors for you to obtain competitive prices
- Maintenance and after sales services: detailed instruction manuals are available at every stage. Your Altro consultant can provide advice on cleaning and maintenance
- CPD Service: A range of CPDs covering flooring and walling issues, for more details, visit [www.altro.com](http://www.altro.com)

### Altro leave nothing to chance

- Altro extensively test all products to ensure that they meet recognised independent standards
- Warranties: Altro offer market leading warranties
- Training & technical know-how: to ensure high industry standards and best practice, Altro offer product and installation training through the Altro Centre of Excellence
- Low life cycle costs: due to easy maintenance and high durability, Altro products offer savings over traditional products
- Proven hygienic and safety systems: proven to offer consistent high quality and performance, Altro have a large customer base in the education sector and can arrange visits to existing sites





# altro

## PRODUCT SUGGESTIONS

These represent typical but not exclusive applications, please contact Altro for your specific requirements.

Area	Classrooms	Laboratories	Corridors	Toilets	Showers	Changing/locker rooms	Kitchen
Altro Mirica	•		•	•			
Altro Stronghold 30 / K30							•
Altro Maxis 25		•	•	•			
Altro Suprema	•		•	•			
Altro Timbersafe II	•		•				
Altro Walkway 20 / VM20	•		•	•		•	
Altro Marine 20 / T20					•	•	
Altro Classic 25 / Altro Designer 25		•				•	•
Altro 40 / X40						•	
Altro XpressLay	•		•	•		•	
Altro Art	•	•	•	•	•	•	•
Altro Mondosport I & II / Altro Mondoflex I & II							
Altro Ramflex		• **					
Altro Whiterock		•	•	•	•	•	•
Altro Whiterock Satins		•	•	•	•	•	•
Altro Whiterock Illusions/Stone				•	•	•	
Altro Whiterock Chameleon				•	•	•	
Altro Whiterock Digiclad							
Altro Whiterock Splashbacks	•	•		•			
Altro Solosafe		•		•	•	•	•
AltroCast TB	•		•				
Altrocrete PU Excel / AltroCrete PU HD Fast Track		•					•
AltroCast / AltroCast Plus Quartz					•		•
Altro Screed Quartz		•	•				
AltroSmooth Chrysalis / AltroSmooth Synthesis / AltroSmooth Ethos	•		•				

*Note: this table lists the range of Altro products which may be suitable for specific areas and are guidelines only as local regulations may differ. Please consult your local Altro representative before specification.*

*\*Please contact Altro Technical Services for advice regarding staining from hair dyes and wax deposits.*

*\*\* Altro Ramflex for labs: in universities where liquid oxygen and nitrogen stills are located, Altro Ramflex can be used sacrificially.*







School hall/ sports hall	Gym/Fitness	CDT	Cafeteria/ dining hall	Nurseries	Reception	Student Union Bar	Hairdressing*	Accommodation	Wet Play Areas	Swimming & Hydrotherapy
			•	•	•		•	•	•	
			•		•	•				
			•	•	•		•	•	•	
			•	•	•		•	•	•	
				•				•	•	
								•		•
		•				•				
		•								
				•				•	•	
•	•	•	•	•	•	•	•	•	•	•
•	•									
	•									
			•	•				•		•
			•	•	•			•		•
			•	•	•			•		•
			•	•	•	•	•	•	•	•
•			•	•	•	•	•	•	•	•
		•		•			•	•	•	
		•								
					•					
		•								

BY SPECIFYING ALTRO YOU CAN BE CONFIDENT IN YOUR CHOICE. FOR FURTHER PRODUCT DETAILS, TO ORDER SAMPLES OR ARRANGE AN ON-SITE CONSULTATION, CALL TODAY ON

**+44 (0) 1462 707600**

OR VISIT [www.altro.com](http://www.altro.com)





# altro FLOOR PLANS

## School

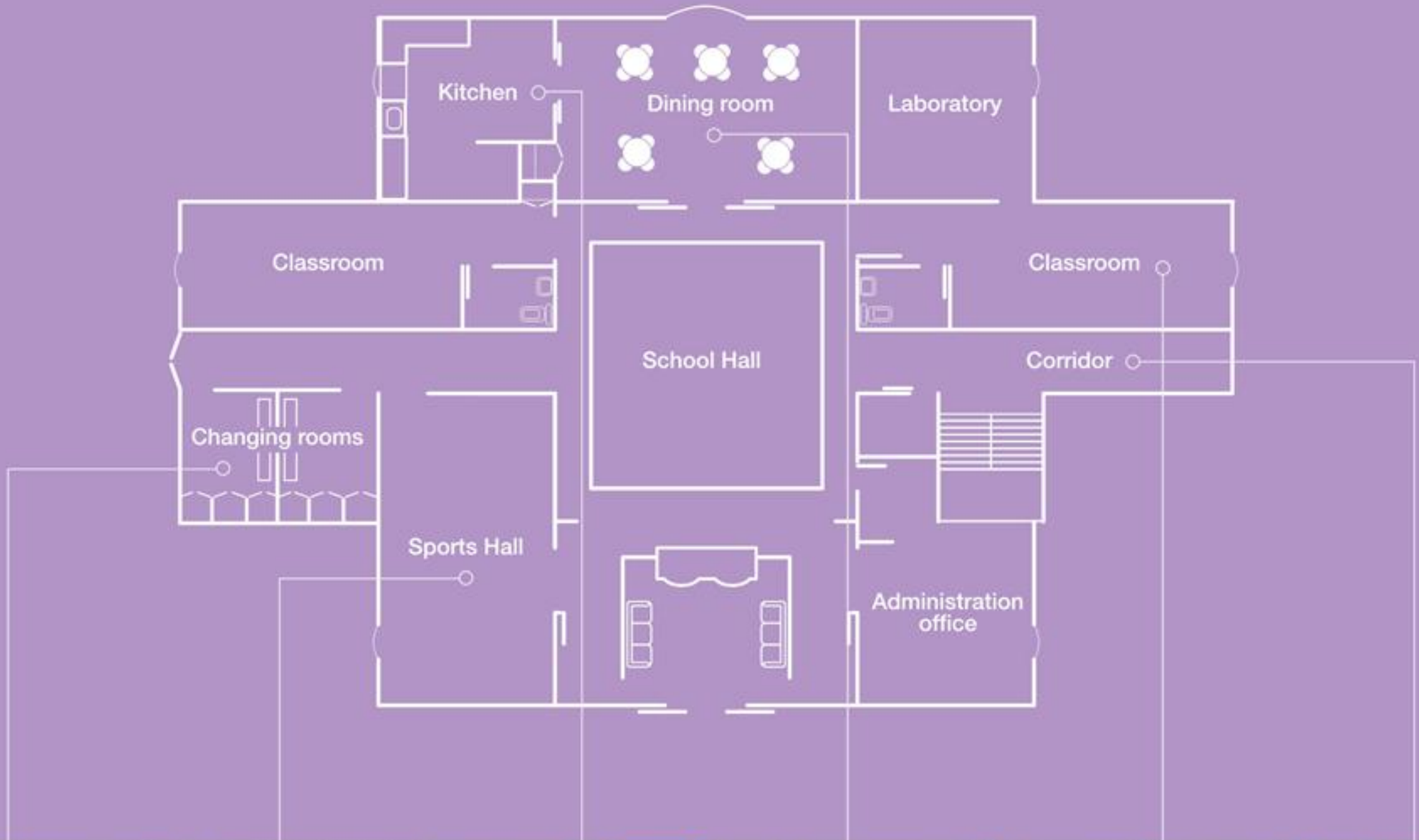



## University

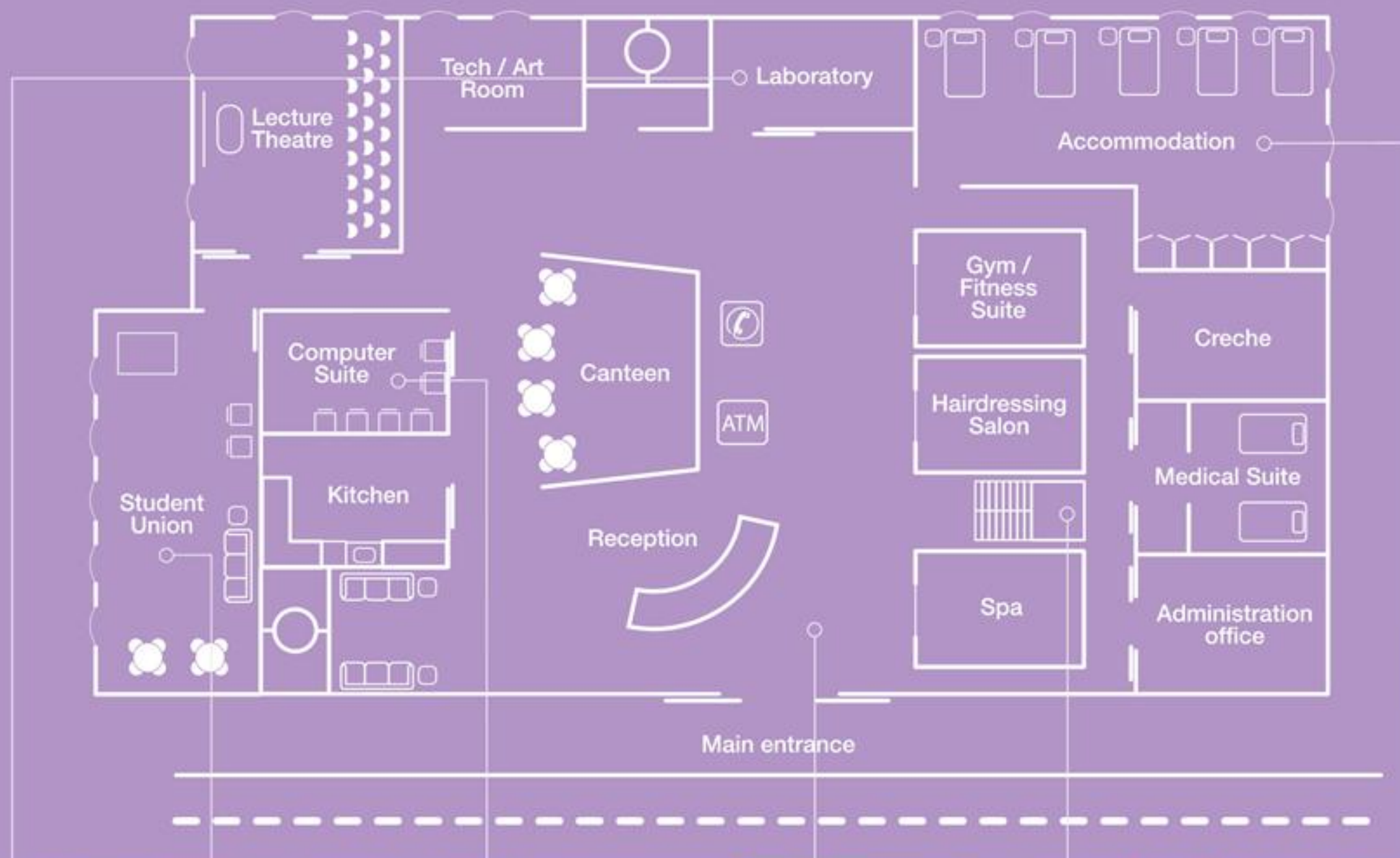

+44 (0) 1462 707600 [www.altro.com](http://www.altro.com)





# altro



## Case Studies

Location: **Manchester Metropolitan University**

Product: **Altro Whiterock™**

"Durability, longevity and ease of maintenance were important factors in our selection and Altro provided the ideal solution. We've worked with Altro on a variety of projects and they never let us down.

Altro Whiterock is much easier to keep clean than tiles, its smooth, seamless finish means there's no grout for dirt and bacteria to build up in, plus there's no danger of cracks that need to be repaired with replacement tiles. Our cleaning and maintenance teams are as pleased as the students."

Eddie Lea, Estates Services Manager

Location: **The Petchey Academy, Hackney**

Product: **Altro Maxis 25™, Altroscreed™ Quartz, Altro Stronghold™ 30 and Altro Whiterock™**

"We really were amazed at the quality and finish of the new building, especially the floors and walls from Altro. They have created the perfect setting to promote learning and growth."

David Daniels, Head Teacher

"The client has chosen a very hard-wearing but aesthetically pleasing material and we believe the school has an example of Altroscreed Quartz at its best."

Grant Machen, Director, Resintek Services Ltd

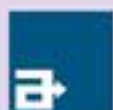



## Education Sector Specification Considerations

### Flooring

Skirting type  
Drainage / existing substrate  
Inspection covers / manholes  
Expected regularity of furniture movement  
Activities in areas (eg wet, dry play, multi-purpose, sports, assemblies)  
Intensity of traffic  
Heaviness of footfall  
Shoed or barefoot traffic  
Acoustics  
Proposed cleaning and disinfection regime  
Ground floor or upper floor location  
Spillages of food  
Potential for tracked in dirt  
Barrier matting  
Colour coding requirement  
Contrasting colours required for inclusive design  
Inclusive design requirement  
Time available for installation

### Walls

Existing substrate / wall finish  
Extra impact resistance required  
Pipes, vents, ducts, wall furniture, window and door frames  
Colour / colour contrast finish requirement  
Hygiene requirement  
Proposed cleaning and disinfection regime  
Time available for installation  
Coved skirting to avoid tight corners for hygiene and easy cleaning

### Ceilings & doors

Vision panels in doors  
Need for colour contrast on doors and frames or walls and ceilings  
Natural, direct or surface fixed lighting  
Ceiling access  
Cleaning regime  
Time available for installation

**+44 (0) 1462 707600   [www.altro.com](http://www.altro.com)**





# THE ENVIRONMENT

## BRE "A+" rating

Altro have consistently led the way in formulating and designing sustainable safety flooring, utilising advanced manufacturing processes. Our safety flooring products achieve the highest possible BRE Global environmental rating of A+ in an Education application, confirming what the industry has always known to be true that, when viewed over their entire life cycle, PVC based safety flooring products can offer the best environmental credentials, whilst maintaining a high degree of slip resistance and durability.

A+ BRE Generic Green Guide Rating for Safety Flooring, full details available at [www.thegreenguide.org.uk](http://www.thegreenguide.org.uk)

## Clean environments matter

- Altro have reduced water consumption by 99% over 10 years
- Altro recycle all production waste PVC
- Altro have reduced waste to landfill by over 70% since 2007
- Altro safety flooring is 100% recyclable
- Altro safety flooring uses 100% recyclable packaging
- Altro recycles traditional safety flooring into new safety flooring
- Altro are the first manufacturer to do so
- Products with Altro Easyclean Technology™ need fewer chemicals and less water to maintain them over their life span, thereby reducing their carbon footprint

## 6 Steps to Sustainability

Altro are passionate about minimising the impact our products and processes have on the environment. Discover more about our holistic approach to sustainability by visiting [www.altro6steps.com](http://www.altro6steps.com)

## Recofloor

Altro are one of two of the country's leading flooring manufacturers, who have launched the UK's first vinyl flooring recycling take-back scheme. Recofloor will increase the recycling of waste vinyl flooring in the UK. Through the scheme, safety flooring and smooth vinyl offcuts from the installation process will be recycled back into new flooring. Unique in our safety flooring recycling capabilities, Altro collect and recycle all the safety flooring for Recofloor, irrespective of manufacturer. Uplifted, or end-of-life material, will be used in the manufacture of traffic calming products, such as traffic cone and road barrier bases.

The target is to create a sustainable, cost-effective and efficient collection system. Waste flooring will be accepted from all sources, from individual contractors to large construction projects.

Registered Recofloor participants will be provided with bulk bags which can be collected from site when filled with vinyl flooring, or they can drop off waste at one of 19 designated drop-off sites across the UK.





# altro SOLUTIONS

## ALTRO RESINS

Functional and decorative, resin floors are the toughest available for demanding education environments. Able to withstand high temperatures, impact, heavy abrasion and high point loading, while affording safety underfoot, seamless resin floors will provide optimum service.

Suitable for functional areas such as kitchens, refectories, store rooms, technology rooms, laboratories, corridors, shower areas and toilets, the applications for resin floors are as varied as they are challenging.

## Benefits

### Hygienic

- Seamless and impervious
- Zero water absorption (Pu)
- Anti-bacterial properties
- Independently performance-tested
- Withstand impact and high point loading
- Cut and chemical resistant

### Slip-resistant

- Texture throughout reduces the risk of slips and trips
- Safety for staff and students in slip-risk areas
- Tailored surface texture to meet your specification

### Long lasting

- 2-10 year warranties
- Durable, cost-effective



### Easy to clean

- Minimal joints for ease of cleaning
- Can be coved and integrated with drainage to facilitate wash down

### Enhances the working environment

- Functional and decorative systems available

### Installation features

- Can be repaired if required
- Self-coveable
- Can be laid to falls
- Compatible drainage systems available
- Minimal installation downtime options





## Product Details

Typical applications are shown in italics. These do not represent an exclusive list. For your exact project requirements please contact Altro directly.

### All Altro Resins provide:

- Robust and versatile flooring
- Superb functional performance
- Seamless, impervious coveable membrane
- Ease of cleaning
- Protection against bacteria

*MAIN KITCHENS, TECHNOLOGY ROOMS, HEAVY DUTY LABORATORIES, PRINT ROOMS*

### AltroCrete PU Excel™

- Low potential for slips
- From 5mm thickness for economy
- 9mm thickness for high temperatures, up to 120°C
- High abrasion resistance
- Minimal installation downtime option

*LIGHT DUTY KITCHENS, LABORATORIES, ELECTRONICALLY SENSITIVE AREAS, CIRCULATION AREAS*

### AltroScreed™ Quartz EP

- Grade available to dissipate static electrical charge
- Low slip risk option
- 4mm thickness for economy, 6mm for durability
- Decorative, economical, easy to clean

*BATHROOMS, CHANGING ROOMS, SWIMMING POOLS, CIRCULATION AREAS*

### AltroCast™ / AltroCast™ Plus Quartz

- Extremely low potential for slips
- 1mm-4.5mm thickness options
- Decorative and economical

*BATHROOMS, CHANGING ROOMS, LABORATORIES, TECHNOLOGY ROOMS, LIGHT DUTY KITCHENS*

### NEW Altro Solosafe™

- Rapid 24-hour installation
- Slip, scratch, impact, fire and cigarette resistant
- Available in 8 colours

### ALSO AVAILABLE:

AltroSeal™, AltroShield™, AltroCoat™, AltroTect™ seals to treat concrete walls and floors.

Altro Terrazzolite EP™ sophisticated, marble-look finishes for a touch of class.

Altro Pebblestone™ highly decorative and versatile for reception, circulation and pool areas.

Altro Mosaic™ Texture powerful visual statement in washrooms, canteens and circulation areas.







### Altro resin cove detail – Altro Whiterock™ overlap transition

\*Not supplied by Altro

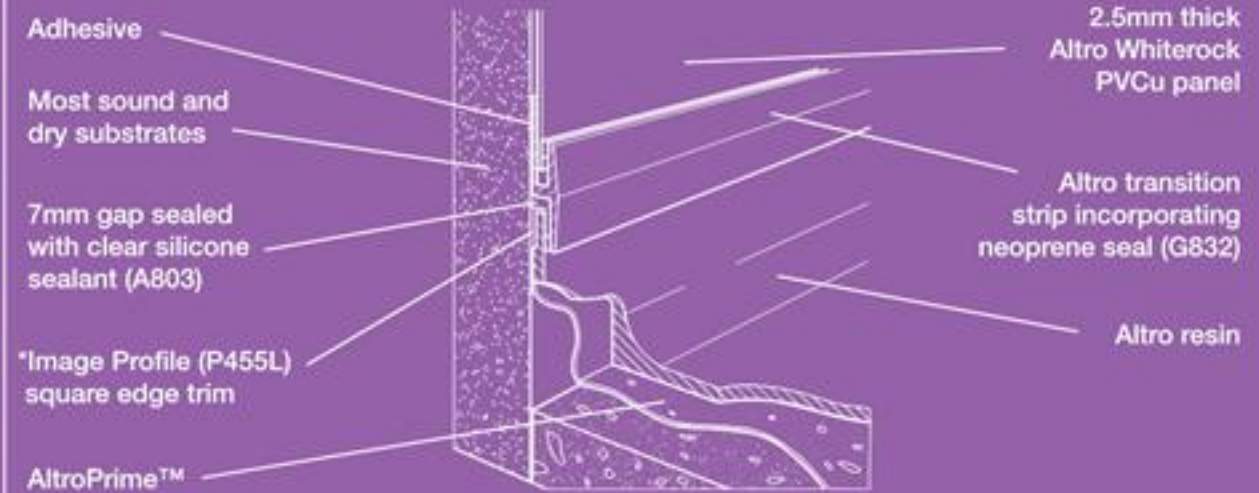

### Altro resin poured trench drain transition

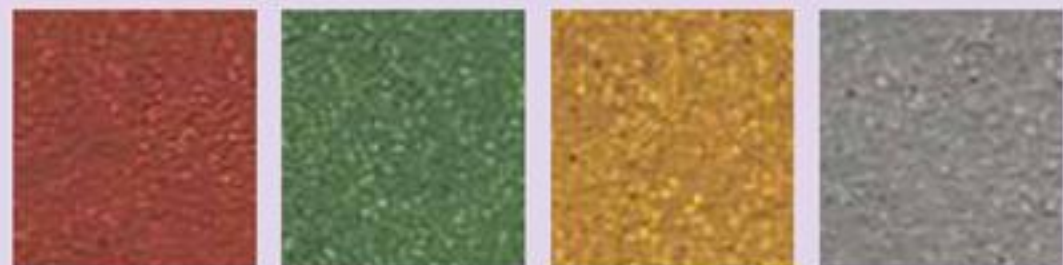
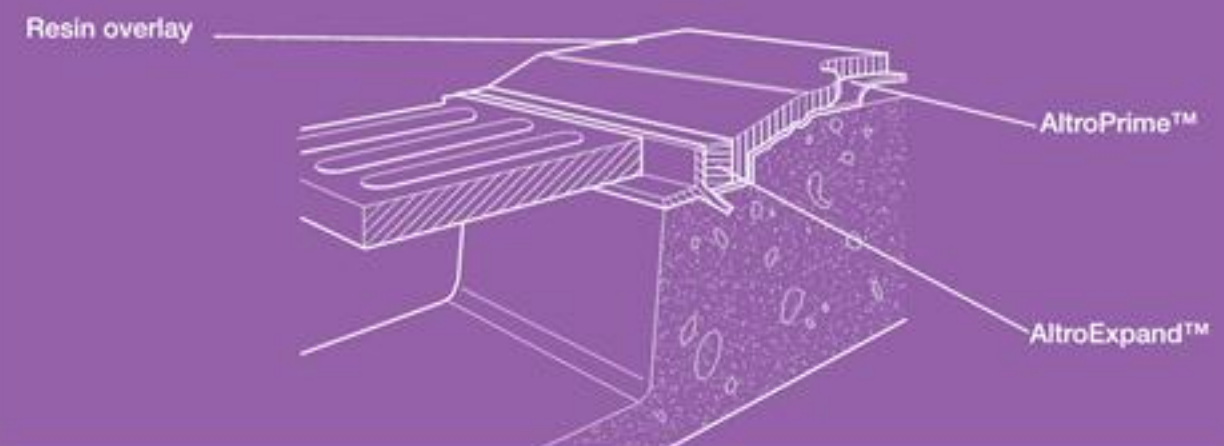

FOR FURTHER PRODUCT DETAILS, TO ORDER SAMPLES OR  
ARRANGE AN ON-SITE CONSULTATION, CALL TODAY ON

**+44 (0) 1462 707600**

OR VISIT [www.altro.com](http://www.altro.com)







## Case Studies

Location: **Manchester Art College**

Product: **AltroScreed™**

"It's key that we create a good impression in our reception area, making sure we give off a welcoming, bright and airy feel for visitors, students and staff. We also want the area to help our students relax between lectures or give them space for reflection, so the environment has to respect their requirements. The choice of flooring, fixtures and fittings all play a role in this."

Mark Vernon, Estates Manager at MANCAT



Location: **St Christopher's School, Letchworth**

Product: **AltroScreed™ Quartz EP**

"We knew this flooring would be the perfect solution. Being in a high traffic environment, the floors take a lot of punishment, so durability is obviously an issue. This product is extremely hard-wearing and very easy to clean."

Sue Horner, Business Manager



# altro SOLUTIONS

## ALTROSMOOTH™ FLOORING

AltroSmooth flooring ranges are most suitable for areas where the likelihood of spillages is low, including offices, certain classrooms and corridors. They can be welded to provide a seamless, hygienic finish, which is easy to clean and maintain. AltroSmooths are hard-wearing and require low maintenance; in addition, they are available in a wide range of attractive natural or decorative finishes for areas where aesthetics are a priority.

### Benefits

#### Easy to clean

- Factory finish PU & PUR protection
- Can be coved for ease of cleaning

#### Enhances the working environment

- Choice of decorative finishes
- Appearance retention
- Hard-wearing
- Design and cut options for flexibility of design

#### Hygienic

- Seamless, hygienic surface

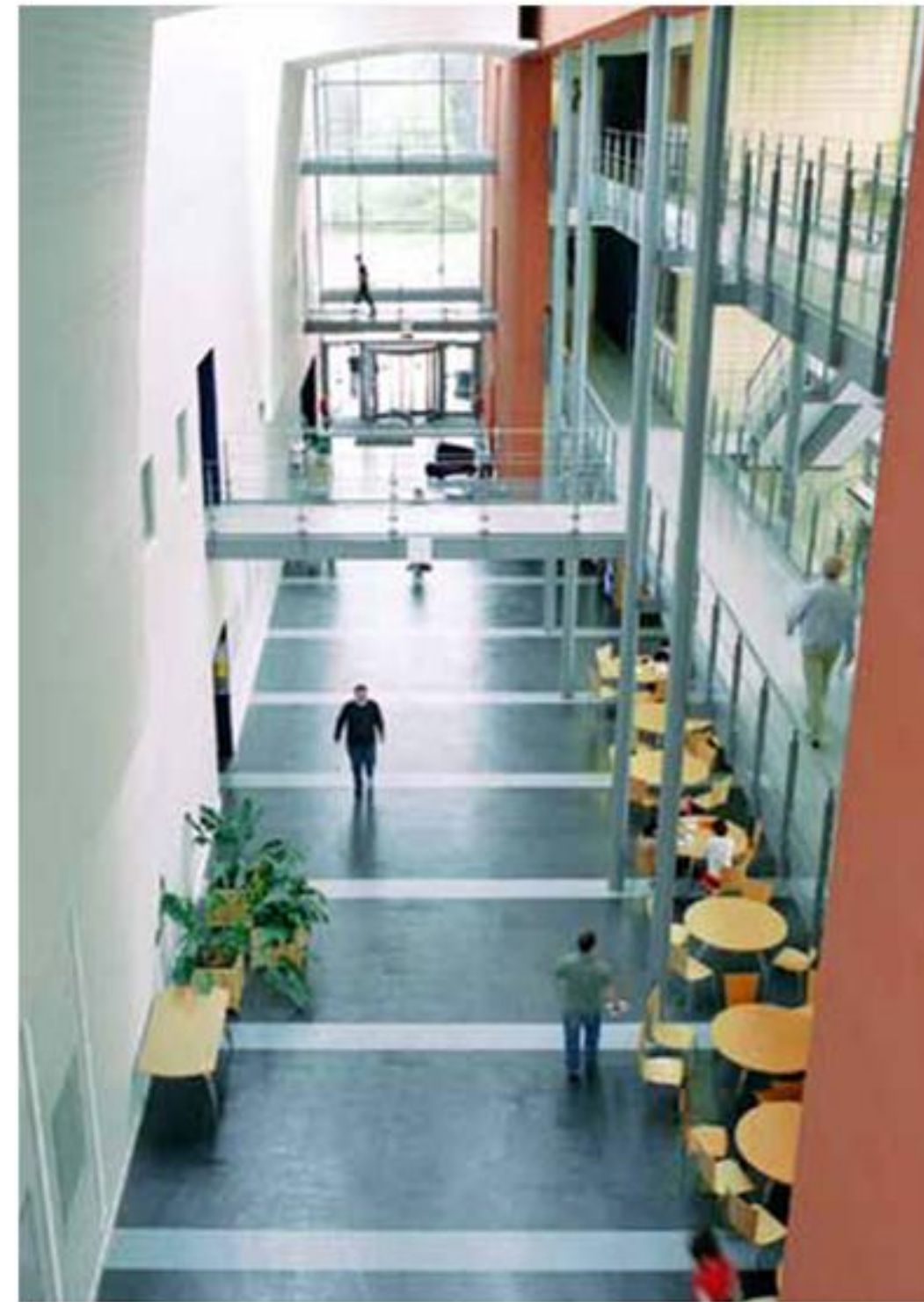



## Product Details

Typical applications are shown in italics. These do not represent an exclusive list. For your exact project requirements please contact Altro directly.

### All AltroSmooth™ products:

- Hard-wearing
- Easy to clean and maintain
- Excellent appearance retention

*COMMON ROOMS, GAMES ROOMS, CIRCULATION AREAS*

### AltroSmooth Ethos™

- Sheet flooring with timber appearance
- 10 colour options
- Seamless, hygienic surface
- Factory finish PU coating

*HEAVY-DUTY CORRIDORS, CIRCULATION AREAS*

### AltroSmooth Synthesis™

- Available in 14 colours, with translucent chip effect
- Homogeneous
- Factory finish PUR coating

*HEAVY-DUTY CORRIDORS, RECEPTION AND CIRCULATION AREAS*

### AltroSmooth Chrysalis™

- Subtle abstract effect
- Available in 16 colours
- Homogeneous
- Factory finish PUR coating

*GENERAL STORAGE ROOMS/AREAS*

### AltroSmooth Intrinsic™

- Natural designs in a selection of 12 contemporary colours
- Homogeneous
- Factory finish PU coating





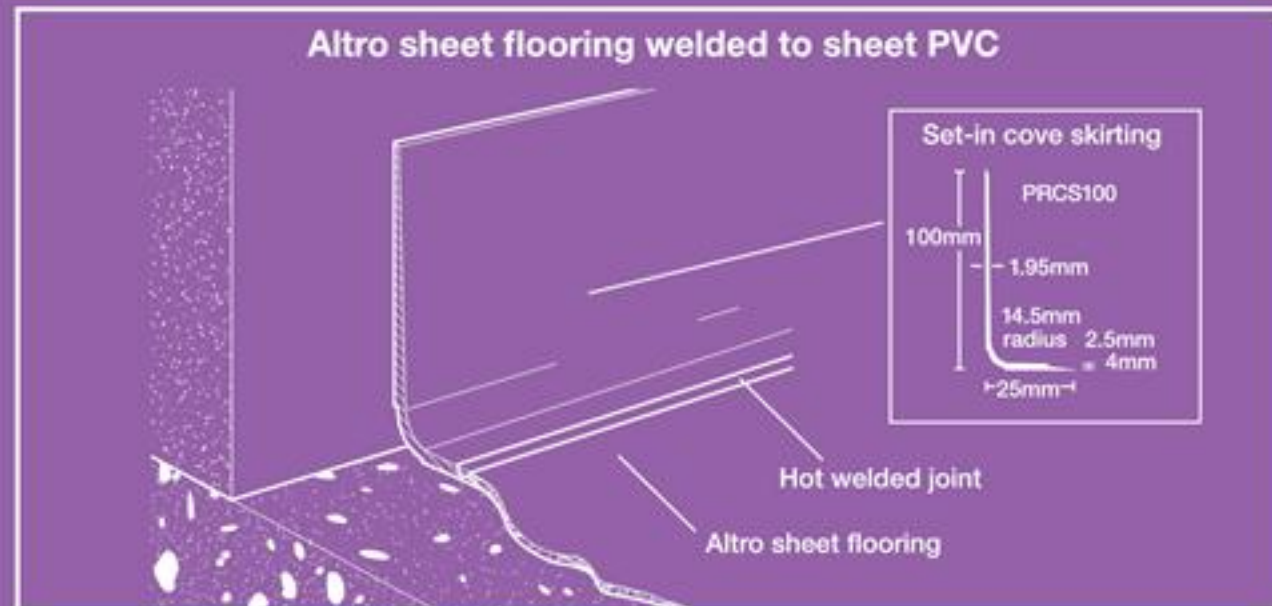
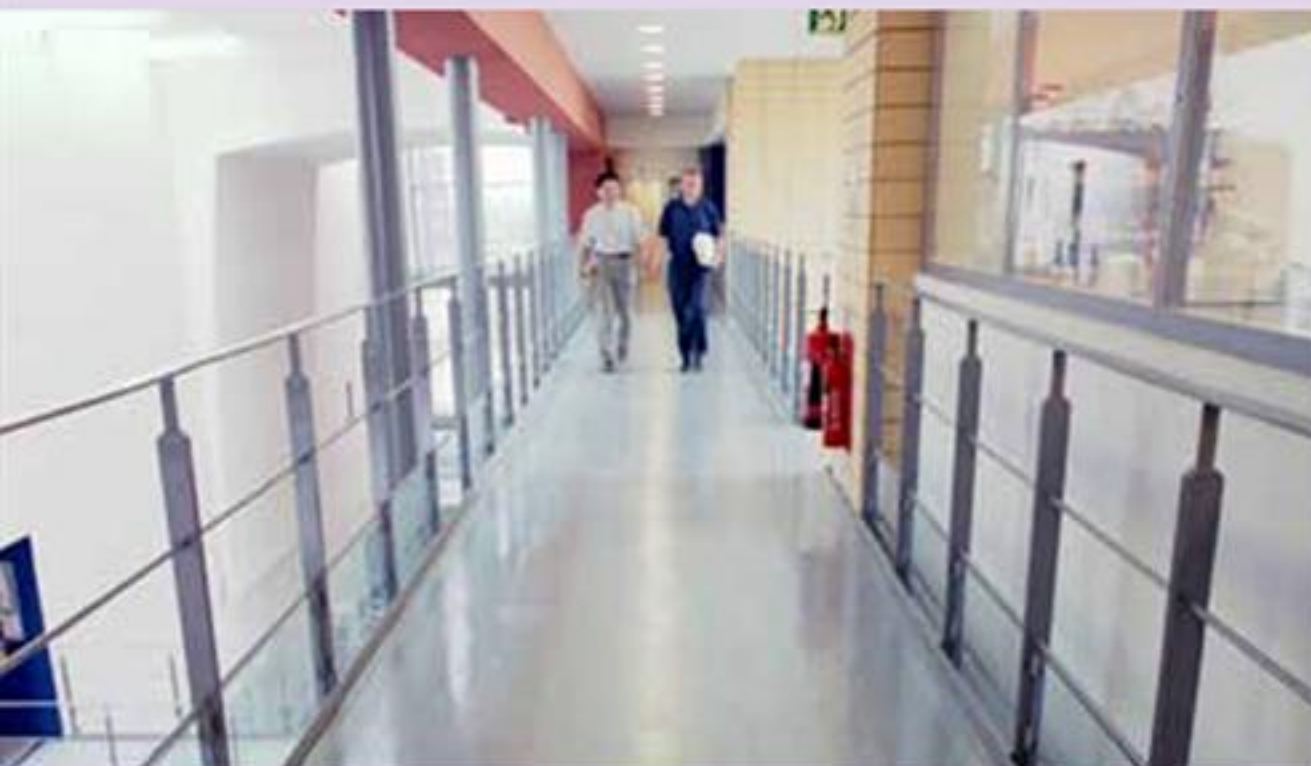

FOR FURTHER PRODUCT DETAILS, TO ORDER SAMPLES OR  
ARRANGE AN ON-SITE CONSULTATION, CALL TODAY ON

**+44 (0) 1462 707600**

OR VISIT [www.altro.com](http://www.altro.com)







## Case Studies

Location: **John Henry Newman Roman Catholic  
Secondary School, Stevenage**

Product: **AltroSmooth Ethos™**

"We chose Altro for this project as we were impressed by their reputation and customer service. We are absolutely delighted with the results, the project ran smoothly and Altro lived up to their promise. I would not hesitate to recommend Altro to other education establishments."

Valerie Culpin, Business Manager



# altro SOLUTIONS

## ALTRO SPORTS FLOORS

From spectator stands to athletics tracks, basketball courts to gymnasias, you will find Altro sports surfaces in prestigious education establishments. Our extensive range of materials, textures and colours mean that Altro sports surfaces will not only meet but exceed your most demanding performance requirements. No one is more qualified than Altro to meet the unique challenges of your sports environment.

## Benefits

### Shock absorbency

- Athletes cushioned from stress and strains

### Subfloor preparation

- Ensures optimum performance
- Fast-track installation

### Wide range of surfaces

- Long lasting
- Can be laid over existing wooden floor
- Enhanced underfoot traction, plus Altro Everlay™ underlay for enhanced performance



## Standards

- Tested to BS EN 14904
- Approved by over 30 international associations, including International Basketball, Badminton, Volleyball and Handball Federations

## Olympics

- Mondo has been fitted in the last nine Olympic Games





## Product Details

Typical applications are shown in italics. These do not represent an exclusive list. For your exact project requirements please contact Altro directly.

### *MULTI-USE FACILITIES, SPORTS HALLS*

#### **Altro Mondosport™**

- Hard-working, slip-resistant
- In 7 colours plus wood-effect
- Seamless, hygienic, low maintenance
- Shock absorbent
- 2.5 or 4.5 mm thickness

### *MULTI-USE, GYMNASIA*

#### **NEW Altro Mondosport™ II**

- 8mm thickness
- Consistent ball bounce
- Permanent anti-bacterial treatment to prevent micro-organism growth
- Optimal traction and friction for comfortable play
- BS EN 14904 compliant system

### *MULTI-USE FACILITIES, SPORTS HALLS*

#### **Altro Mondoflex™**

- Smooth rubber finish
- Hard-working, slip-resistant
- Seamless, hygienic, low maintenance
- Minimises abrasion injuries
- Excellent acoustic values
- 4mm thickness

### *MULTI-USE FACILITIES, SPORTS HALLS*

#### **NEW Altro Mondoflex™ II**

- Superior construction and performance
- Minimises abrasion injuries
- Optimal friction
- Unrivalled shock absorption, durability and traction allow for acceleration and directional changes
- 7.5mm thickness
- BS EN 14904 compliant system

### *GENERAL, INDOOR TRACKS AND BALL SPORTS*

#### **Altro Mondo Sportflex™**

- Excellent bounce and underfoot characteristics
- Excellent acoustic values
- Tough, 4.5 and 6mm thickness

### *WEIGHTLIFTING, GYMNASIA*

#### **Altro Mondo Ramflex™**

- Tough, resilient rubber
- Suitable for heavy point loading and free weights areas
- 8mm thickness, tile size 1m x 1m







### Sports stadia, specialist system

Altro Mondo Premier Plus™

Upgrade Altro MondoSport and Altro Mondoflex to a professional level sports system

- BS EN 14904 area elastic sprung system

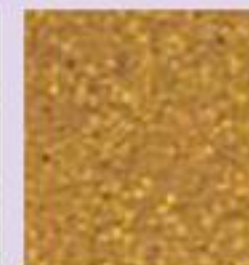

FOR FURTHER PRODUCT DETAILS, TO ORDER SAMPLES OR  
ARRANGE AN ON-SITE CONSULTATION, CALL TODAY ON

**+44 (0) 1462 707600**

OR VISIT [www.altro.com](http://www.altro.com)







## Case Studies

Location: **The Radclyffe School (Academy), Oldham**

Product: **Altro Mondo Ramflex™ and Altro Mondo Sportflex™**  
Plus Altro Impressionist™II and Altro Walkway™

"The floor had to be really hard-wearing due to the consistent use. It also needed to be easy to clean, slip resistant and attractive. Everyone at the school is really impressed with the end product, it really does look great and above all it is practical. All sorts of sports can be played on it and we can roll out heavy objects such as table tennis tables and the floors don't mark. The floor also looks like new every time it is cleaned, which is fantastic."

Debbie Wood, Deputy Head Teacher



Location: **St Joseph's College, Ipswich**

Product: **Altro Mondoflex™**

"Altro Mondoflex was installed as part of a complete refurbishment of the sports hall at St Joseph's College. As is often the case, timescales and budgets were tight and we had to find a product that met all of the requirements for safety, durability and aesthetics, whilst minimising the amount of time the hall was out of use. Altro Mondoflex offered a unique solution as the system's lack of depth meant that we were able to lay the new flooring over the existing floor, saving considerable time and money."

4Runner Ltd, Contractor





altro

the future is safer with altro



, Altro, Altro Mirica, Altro Suprema, Altro Timbersafe II, Altro Walkway 20, Altro Stronghold 30, Altro Marine 20, Altro Atlas 40, Altro Designer 25, Altro Classic 25, Altro Impressionist II, Altro Maxis 25, Altro Stonesafe II, Altro XpressLay, Altro Everlay, Altro Whiterock, Altro Whiterock Satins (incorporating Altro Whiterock Pastels), Altro Whiterock Illusions and Stone, Altro Whiterock Chameleon, Altro Whiterock Chameleon Art, Altro Whiterock Digiclad, Altro Whiterock Splashbacks, AltroCrete PU Excel, AltroScreed Quartz EP, AltroCast/ AltroCast Plus Quartz, Altro Solosafe, AltroSeal, AltroShield, AltroCoat, AltroTect, Altro Terrazzolite EP, Altro Pebblestone, Altro Mosaic Altro Mondosport I, Altro Mondosport Wood, Altro Mondosport II, Altro Mondoflex, Altro Mondoflex II, Altro Mondo Sportflex, Altro Mondo Ramflex, AltroSmooth Ethos, AltroSmooth Synthesis, AltroSmooth Chrysalis, AltroSmooth Intrinsic, Altrosan, Altro Maxis Easyclean Technology are all trademarks of Altro Limited.